



Larchwood, The Crescent, Cheadle

£115,950

🛏 1 🍳 1 🛋 1

- Well presented retirement apartment
- Cheadle village location
- Lovely lounge
- Fitted kitchen
- Double bedroom
- Attractive shower room
- Beautiful communal gardens
- Off road parking
- House manager on site
- EPC: D



An Excellent 1st floor retirement apartment featuring hall, lounge, good sized bedroom with fitted wardrobes, fitted kitchen with built in oven and hob, and shower room. In addition there is a communal lounge and laundry. Lift and stair access. For peace of mind there is a resident house manager and emergency pull cords in each room. Conveniently situated within walking distance to Cheadle Village centre. Viewing is essential!!



GROUND FLOOR

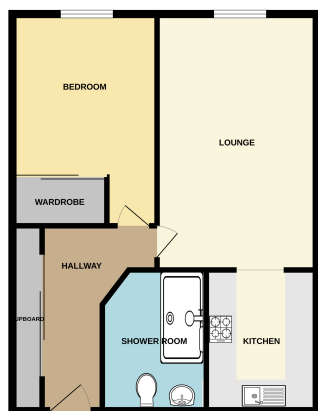

Whilst every attempt has been made to ensure the accuracy of the figures contained here, measurements of actual spaces should be used for the purpose of determining the suitability of the property for your intended use. The information is provided for general guidance only and should not be relied upon for any specific purpose. The information is provided for general guidance only and should not be relied upon for any specific purpose. The information is provided for general guidance only and should not be relied upon for any specific purpose.



9 Gatley Road, Cheadle, Cheshire SK8 1LY Tel. 0161 428 1488 Fax. 0161 428 1479
Email. mail@andrewdawson.co.uk